



# MR16 UV Cut with Cover Glass

These MR16 low voltage halogen lamps with UV Cut cover glass are the perfect lighting option when delicate items are being illuminated. The UV reduction lens minimizes damage to merchandise and materials over time.

## Features

- UV-Cut lens
- Crisp white light
- Long lasting dichroic coating
- Precise optical design

## Applications

- Fabrics
- Museums
- Residential
- Art galleries
- Apparel stores

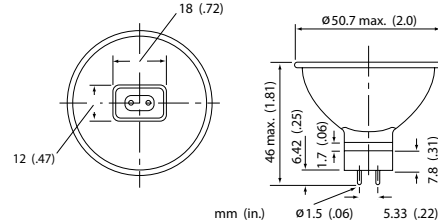

Order code	Description	ANSI code	Watts (W)	Base	Volts (V)	Colour temp. (K)	Beam angle (°)	CBCP*	Average life (hrs)	MOL** (in.) (mm)	Pack/Case Qty
------------	-------------	-----------	-----------	------	-----------	------------------	----------------	-------	--------------------	------------------	---------------

## MR16 UV Cut

30445	20MR16CG/FL/UVC BAB EYE	BAB	20	GU5.3	12	2 950	38	500	4 000	1.81 46	12/120
30447	35MR16CG/NFL/UVC FRA EYE	FRA	35	GU5.3	12	3 050	23	2 300	5 000	1.81 46	12/120
30448	35MR16CG/FL/UVC FMW EYE	FMW	35	GU5.3	12	3 050	38	1 100	5 000	1.81 46	12/120
15553	50MR16CG/SP/UVC EXT EYE	EXT	50	GU5.3	12	3 050	13	9 800	5 000	1.81 46	12/120
15557	50MR16CG/MFL/UVC ENL EYE	ENL	50	GU5.3	12	3 050	32	2 250	5 000	1.81 46	12/120
30452	50MR16CG/FL/UVC EXN EYE	EXN	50	GU5.3	12	3 050	38	1 600	5 000	1.81 46	12/120
59834	50MR16/CG/UVC/FL/10M/3450K EXN EYE	EXN	50	GU5.3	12	3 450	36	1 300	10 000	1.81 46	12/120
15558	65MR16NSP/CG/UV/FPA EYE	FPA	65	GU5.3	12	3 050	13	12 000	5 000	1.81 46	12/120
59820	20MR16/CG/UVC/SP/10M ESX EYE	ESX	20	GU5.3	12	2 950	9	4 000	10 000	1.81 46	12/120
59821	20MR16/CG/UVC/NFL/10M BBF EYE	BBF	20	GU5.3	12	2 950	23	880	10 000	1.81 46	12/120
59822	20MR16/CG/UVC/FL/10M BAB EYE	BAB	20	GU5.3	12	2 950	38	500	10 000	1.81 46	12/120
59823	35MR16/CG/UVC/SP/10M FRB EYE	FRB	35	GU5.3	12	3 050	12	7 400	10 000	1.81 46	12/120
59824	35MR16/CG/UVC/NFL/10M FRA EYE	FRA	35	GU5.3	12	3 050	22	2 200	10 000	1.81 46	12/120
59825	35MR16/CG/UVC/FL/10M FMW EYE	FMW	35	GU5.3	12	3 050	36	1 100	10 000	1.81 46	12/120
59826	50MR16/CG/UVC/SP/10M EXT EYE	EXT	50	GU5.3	12	3 050	12	9 500	10 000	1.81 46	12/120
59827	50MR16/CG/UVC/NFL/10M EXZ EYE	EXZ	50	GU5.3	12	3 050	25	3 100	10 000	1.81 46	12/120
59828	50MR16/CG/UVC/FL/10M EXN EYE	EXN	50	GU5.3	12	3 050	38	1 650	10 000	1.81 46	12/120

\* Center Beam Candle Power  
\*\* Conversions may vary slightly

## Photometrics MR16 UV Cut with Cover Glass

### 20 watts

Beam angle: 38°

$\varnothing$ (in.)	H(ft)	(fc)
25 1/2	3' 3 3/4"	46
52 1/2	6' 6 1/4"	12
78 1/2	9' 10 1/8"	5

30445

### 35 watts

Beam angle: 23°

$\varnothing$ (in.)	H(ft)	(fc)
15 1/2	3' 3 3/4"	214
31 1/2	6' 6 1/4"	53
47 1/2	9' 10 1/8"	24

30447

Beam angle: 38°

$\varnothing$ (in.)	H(ft)	(fc)
25 1/2	3' 3 3/4"	102
52 1/2	6' 6 1/4"	26
78 1/2	9' 10 1/8"	11

30448

### 50 watts

Beam angle: 13°

$\varnothing$ (in.)	H(ft)	(fc)
9 1/8	3' 3 3/4"	910
17 3/2	6' 6 1/4"	228
26 3/2	9' 10 1/8"	101

15553

Beam angle: 26°

$\varnothing$ (in.)	H(ft)	(fc)
17 3/2	3' 3 3/4"	297
35 1/6	6' 6 1/4"	74
53 1/2	9' 10 1/8"	33

15557

Beam angle: 32°

$\varnothing$ (in.)	H(ft)	(fc)
22 1/8	3' 3 3/4"	209
44 3/2	6' 6 1/4"	52
66 3/2	9' 10 1/8"	23

30452

### 65 watts

Beam angle: 13°

$\varnothing$ (in.)	H(ft)	(fc)
9 1/8	3' 3 3/4"	1115
17 3/2	6' 6 1/4"	279
26 3/2	9' 10 1/8"	124

15558